

Master®

90 GUN LOCK
READ BEFORE USE!

⚠ WARNING!
Do Not Use On A Loaded Gun!
Attempts to use on a loaded gun may result in an accidental discharge!



⚠ WARNING!

DO NOT USE THIS LOCK ON A LOADED GUN! Attempts to use on a loaded gun may result in an accidental discharge. A loaded gun must *always* be regarded as dangerous. If the lock becomes damaged in any way do not attempt to use on your firearm – refer to guarantee information for replacement.

Before attempting to use, carefully read all of the following instructions along with the firearms safety tips.

IMPORTANT: We do not guarantee that this product will lock all firearms. It will block access to many guns when properly attached. Some lever action rifles, firearms without trigger guard surrounding the triggers, guns with extra light or extra wide triggers or guns with trigger shoes or extensions may not be able to be effectively locked with this gun lock. **NO GUN LOCK CAN OFFER COMPLETE PROTECTION AGAINST THE ACCIDENTAL OR INTENTIONAL MISUSE OF FIREARMS.** Keep guns unloaded and out of children's reach. Master Lock Company is not responsible for incidental or consequential damages.

Instructions For Use

1. INSERT key and turn to the right (clockwise). SEPARATE both halves of gun lock. REMOVE key from lock. MAKE SURE GUN IS UNLOADED AND NOT COCKED!

RECORD AND SAVE the key number (engraved on each key) in case you lose both keys.

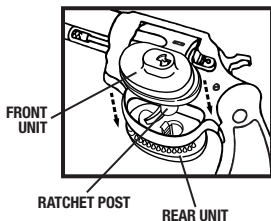

2. INSERT front lock unit (section with key hole) with ratchet post positioned through trigger guard, behind trigger if possible.

3. INSERT rear unit, with outside edges of both units matching. Note that self-adjusting pins usually permit lock to be installed in more than one position.

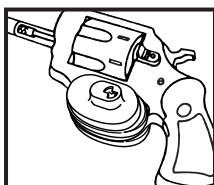
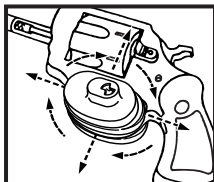

■ While the preceding illustrations (see other side, no. 3) show the preferred and most usual method of using this gun lock, a more effective fit on some guns may be achieved by positioning the lock differently. The ultimate goal is to cover the trigger area as firmly and completely as possible; with the large number of different gun styles available, other lock positions may be more effective.

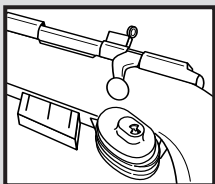
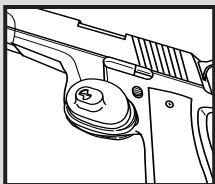

4. After determining best lock position, PRESS the two units together. MAKE CERTAIN that the lock is tight and cannot be moved after it is installed. If it can be, tightly press units together until immovable or try other positions.

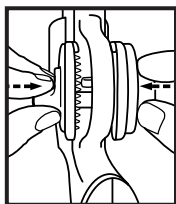

Firearm Safety Tips

1. All firearms should always be assumed to be loaded and should be handled as such.
2. Keep firearms pointed in a safe direction at all times, even when unloaded.
3. Store firearms unloaded under lock and key.
4. Store ammunition separately under lock and key.
5. Never store firearms in a place accessible to children.
6. Teach children basic principles of firearm safety. When encountering a gun:
 - DON'T TOUCH IT!
 - TELL AN ADULT!

Laws concerning firearm ownership, storage and handling vary among states and local jurisdictions. Learn and comply with your state and local laws and those of any jurisdiction to which you plan to transport or use firearms.

Unconditional Full Lifetime Guarantee

This product is warranted to be free from mechanical defects for the life of the product. If a mechanical defect occurs, we'll replace it for free. Just send it to Master Lock Company, 2600 N. 32nd Street, Milwaukee, WI 53210. We'll send you a new lock and a check to cover your postage. No receipt required. MASTER LOCK IS NOT LIABLE FOR INCIDENTAL OR CONSEQUENTIAL DAMAGES. Some states do not allow the exclusion or limitation of incidental or consequential damages, so the above limitation or exclusion may not apply to you. This warranty gives you specific legal rights, and you may also have other rights that vary from state to state.